

**Ground Floor Plan**

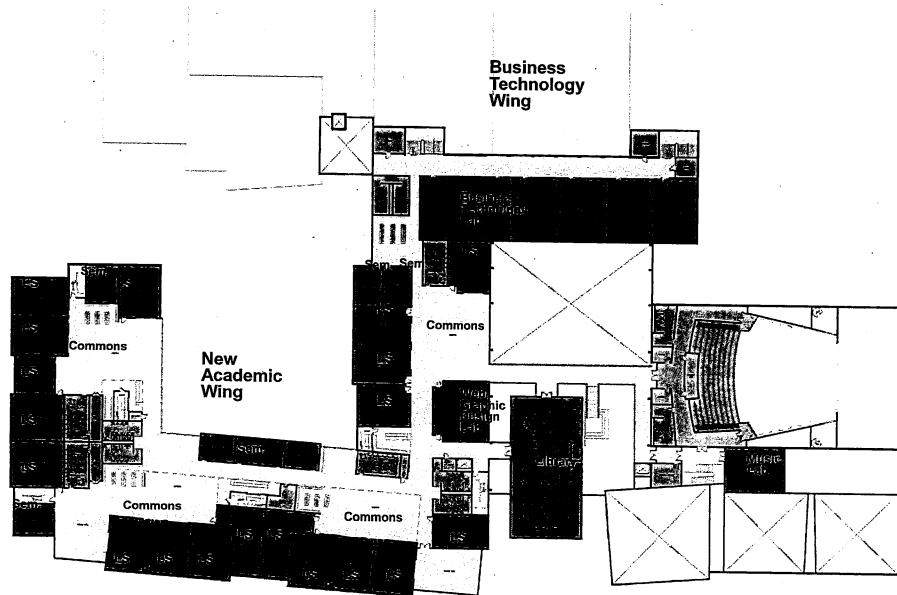

**Second Floor**

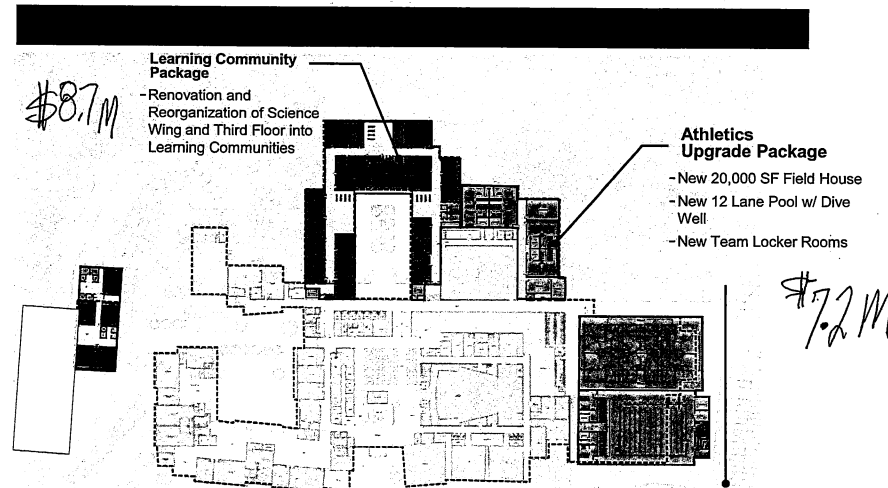

**Options and Packages**

## Pros

- Realize operational savings sooner
- Expedited construction minimizes construction cost
- Two years of transition rather than three
- Informational momentum
- Closure – parents will end this school year knowing the future plan

## Cons

- Election cost approximately \$60K
- Voter participation lighter than in November

**When to ask voters? May 2012**

## Pros

- No special election costs
- Likely largest voter turnout

## Cons

- Project not completed by Fall 2015
  - Lost operational savings \$2.4M - \$1M = \$1.4M
- Three years of transition or risk \$800K design costs
- Construction costs increase with longer schedule
- Informational momentum lost over summer
- Many ballot issues – voter fatigue

**When to ask voters? November 2012**

Package	Square Feet	Cost
Base package hybrid school	331,200 SF	\$65M - \$66M
Relocate Facility Operations		\$1M
Technology equipment		\$2M - \$2.5M
<b>Total program cost</b>		<b>\$68M - \$69.5M</b>
<b>Optional Additional Projects:</b>		
<b>Athletic upgrade package</b>		<b>\$7.1M - \$7.2M</b>
• Replace field house	20,000 SF	\$5M
• Increase pool to 12 lanes	3,000 SF	\$1M
• Replace locker rooms with new	6,500 SF	\$1.2M
Learning Community upgrade	49,700 SF	\$8.6 - \$8.8M
Renovate remaining classrooms		

EXCLUDE  
\$1.1M  
TO MA  
ADMIN. T  
DOYL  
IN  
PROGR  
NOW

## Proposed costs

	Scenario #1	Scenario #2	Scenario #3
Base Package	\$ 66,000,000	\$ 66,000,000	\$ 66,000,000
Athletic Upgrade	-	7,200,000	7,200,000
Learning Community Upgrade	-	-	8,800,000
<b>Package Cost</b>	<b>66,000,000</b>	<b>73,200,000</b>	<b>82,000,000</b>
Relocate Facility Operations	1,000,000	1,000,000	1,000,000
Technology Equipment	2,500,000	2,500,000	2,500,000
Cash on Hand	(11,000,000)	(11,000,000)	(11,000,000)
<b>Bond Request 26 years</b>	<b>\$ 58,500,000</b>	<b>\$ 65,700,000</b>	<b>\$ 74,500,000</b>

**Bond scenarios: with \$11M investment**

- Combine with unified athletics to Bloomfield Hills High School in Fall 2013
- Vacate Andover site for two or three years
- Build hybrid renovation/new construction
- Take Lahser off line, except athletic fields

### **Impact: if the bond passes**

- Implement transition plan: Two or three years depending on ballot timing
  - Grades 10 – 12 to Lahser (possibly a few portables)
  - Grade 9 to Hickory Grove (some shuttles)
  - Adjustments for Lahser Road traffic (offset start/end times, remote parking/shuttling)
  - Temporary Model High School location TBD
  - Approximately \$1M for temporary renovation/portables

### **Impact: if the bond passes**

- Bloomfield Hills High School in Fall 2013 with unified athletics
- Grades 10-12 to Andover campus
- Grade 9 to Lahser campus
- Model High School to Lahser campus
- Seniors only allowed to drive
- Grade 9 for advanced math, shuttle to Andover
- Grades 10-12 for special electives, shuttle to Lahser

### **Impact: if the bond fails**

- Total plan cost = approximately \$35M
  - Construction cost \$5M, maintenance cost \$30M
- Operational savings approximately \$1M
- Address highest priority maintenance first – re-evaluate all sources of funds
- Provides no cosmetic upgrades or instructional enhancements
- Vacate Hickory Grove and take off line
- *Programs cut faster and deeper*

### **Impact: if the bond fails**